

SINGLE STRAND														
Intl. Ref. No.	Chain No.	Pitch (P)	Width between Inner Plates (W) (Min)	Roller Dia (D) (Max)	Plate Height (H) (Max)	Bearing Pin Dia (d) (Max)	Width Over Bearing Pin (A) (Max)	Width Over Joint Fasteners (B) (Max)	Projected Bearing Area (Sq.cm)	Avg. Weight Per Metre (Kg)	DIAMOND MAX Tensile Strength (KN) (Min)	DIAMOND MAX Tensile Strength (KN) (Avg.)	DIAMOND MAX Allowable Load (KN) (Max)	Spares Availability
08B-1	Q083 01	12.70	7.75	8.51	11.81	4.45	17.00	20.90	0.50	0.74	20.79	22.66	4.50	A,B,C,D
10B-1	Q101 01	15.875	9.65	10.16	14.73	5.08	19.60	23.70	0.67	0.98	22.40	29.87	5.60	A,B,C,D
12B-1	Q120 01	19.05	11.68	12.07	16.13	5.72	22.70	27.30	0.88	1.24	29.00	36.69	7.25	A,B,C,D
16B-1	Q160 01	25.40	17.02	15.88	21.08	8.27	22.70	27.30	0.88	1.24	29.00	78.48	15.00	A,B,C,D
20B-1	Q200 01	31.75	19.56	19.05	26.42	10.19	36.10	41.50	2.07	3.30	60.00	116.74	23.75	A,B,C,D

A

B

C

D

E

F

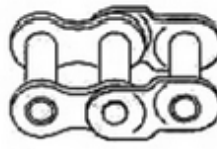
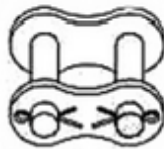

Spares E & F are available for all models

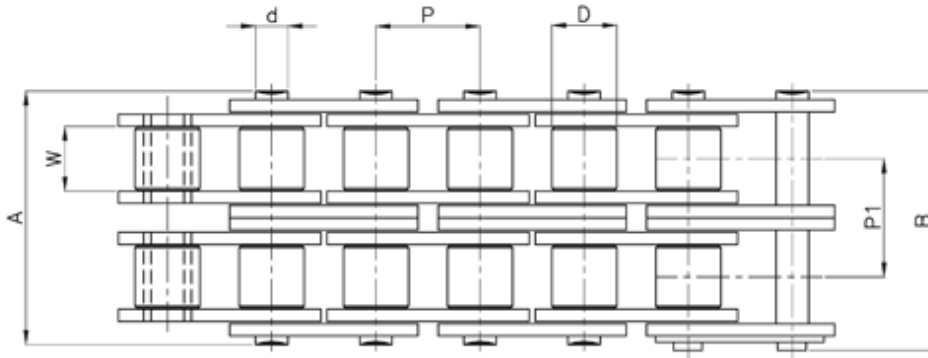
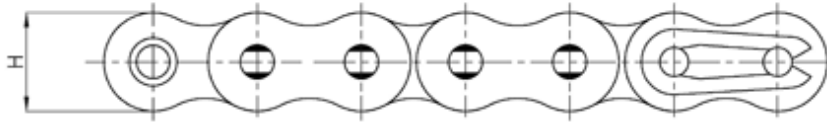

DOUBLE STRAND														
Intl. Ref. No.	Chain No.	Pitch (P)	Width between Inner Plates (W) (Min)	Roller Dia (D) (Max)	Plate Height (H) (Max)	Bearing Pin Dia (d) (Max)	Width Over Bearing Pin (A) (Max)	Width Over Joint Fasteners (B) (Max)	Transverse Pitch (P1)	Avg. Weight Per Metre (Kg)	DIAMOND MAX Tensile Strength (KN) (Min)	DIAMOND MAX Tensile Strength (KN) (Avg.)	DIAMOND MAX Allowable Load (KN) (Max)	Spares Availability
08B-2	Q083 02	12.70	7.75	8.51	11.81	4.45	31.00	34.90	13.92	1.00	1.42	41.58	45.32	A,B,C,D
10B-2	Q101 02	15.875	9.65	10.16	14.73	5.08	36.20	40.30	16.59	1.34	1.88	55.31	59.74	A,B,C,D
12B-2	Q120 02	19.05	11.68	12.07	16.13	5.72	42.20	46.80	19.46	1.76	2.30	66.69	73.38	A,B,C,D
16B-2	Q160 02	25.40	17.02	15.88	21.08	8.27	68.00	73.40	31.88	4.14	5.51	147.10	156.96	A,B,C,D
20B-2	Q200 02	31.75	19.56	19.05	26.42	10.19	79.70	85.80	36.45	5.82	6.91	221.63	233.48	A,B,C,D

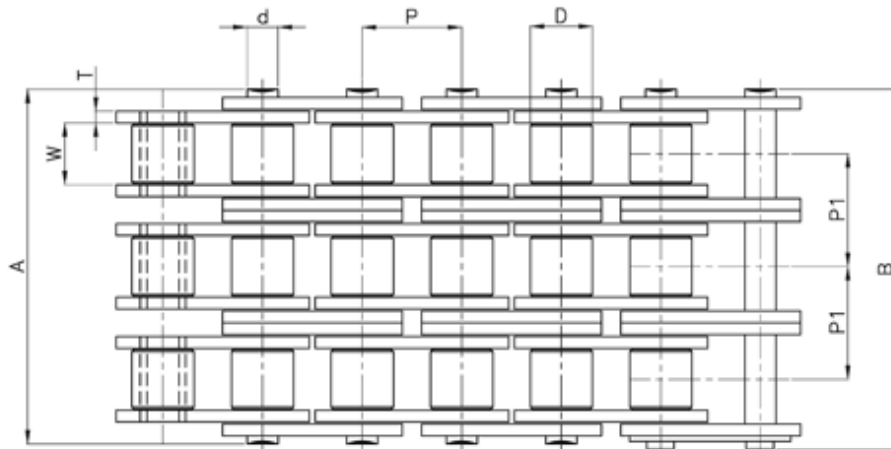
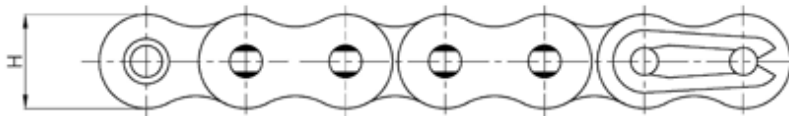

TRIPLE STRAND

Intl. Ref. No.	Chain No.	Pitch (P)	Width between Inner Plates (W) (Min)	Roller Dia (D) (Max)	Plate Height (H) (Max)	Bearing Pin Dia (d) (Max)	Width Over Bearing Pin (A) (Max)	Width Over Joint Fasteners (B) (Max)	Transverse Pitch (P1)	Avg. Weight Per Metre (Kg)	DIAMOND MAX Tensile Strength (KN) (Min)	DIAMOND MAX Tensile Strength (KN) (Avg.)	DIAMOND MAX Allowable Load (KN) (Max)	Spares Availability
08B-3	Q 083 03	12.70	7.75	8.51	11.81	4.45	44.90	48.80	13.92	1.50	2.11	62.37	67.98	A,B,C,D
10B-3	Q101 03	15.875	9.65	10.16	14.73	5.08	52.80	56.90	16.59	2.01	2.79	82.96	89.61	A,B,C,D
12B-3	Q120 03	19.05	11.68	12.07	16.13	5.72	61.70	66.30	19.46	2.64	3.42	100.03	110.07	A,B,C,D
16B-3	Q160 03	25.40	17.02	15.88	21.08	8.27	99.90	105.30	31.88	6.21	8.18	220.65	235.44	A,B,C,D
20B-3	Q200 03	31.75	19.56	19.05	26.42	10.19	116.10	112.20	36.45	8.73	10.26	332.45	350.22	A,B,C,D

Spares E & F are available for all models